

Apr. 24. 2023 11:16AM

No. 4573 P. 1

township of wayne

Assessment Office
475 Valley Road
Wayne, New Jersey 07470

Phone: 973-694-1800
Fax: 973-694-7004

James B. Kreitz, CTA Chief Tax Assessor
Extension 3227

To: Decotiis Law Offices
61 South Paramus Road, Suite 250
Paramus, NJ 07652

Date: April 18, 2023

Subject: Property Owner's List

Attached please find the list of property owners within 200 feet of property known as:

Block: 2711 **Lot:** 105 **Location:** 1207 Hamburg Turnpike, Wayne, NJ 07470

This list was prepared in conformance with the requirements of the Municipal Land Use Law. Any omission and/or failure and/or error, on the part of the person certifying the list shall not invalidate the certification, any hearing, meeting or proceeding.

Certified by:



James B. Kreitz, CTA Chief Tax Assessor
The Assessment Office
Township of Wayne

JK/kt

Wayne Township
475 Valley Road
Wayne, NJ 07470

Notice to Applicants:

Pursuant to the Municipal Land Use Law, C.40:55D-12.h, the following agencies have registered with the Township of Wayne because they are interested in receiving notice of applications for development before either of Wayne Township's land use boards.

Accordingly, in addition to the certified list of property owners provided by the Tax Assessor's Office, the following utilities is considered part of the certified list and notice shall be notified pursuant to the Municipal Land Use Law.

Jersey Central Power & Light
Attn: Craig Mandel, Real Estate
300 Madison Avenue
P.O. Box 1911
Morristown, NJ 07962

Cablevision
Attn: Daniel J. Gannon, NJ North Construction Manager
40 Potash Road
Oakland, NJ 07436

Passaic Valley Water Commission
Attn.: Lisa Bresemann, Paralegal
1525 Main Avenue
Clifton, NJ 07011

Hamburg Turnpike (County Road) Notify:

Passaic County Department of Planning & Economic Development
401 Grand Street, Room 417
Paterson, NJ 07505

Apr. 24. 2023 11:17AM

No. 4573 P. 4

1195 1207 HAMBURG TPKE LLC
1015 HIGH MOUNTAIN RD
FRANKLIN LAKES NJ 07417

1211 HAMBURG LLC % PASHMAN REALTY
601 HAMBURG TURNPIKE
WAYNE, NJ 07470

FIRST NORTHERN STAR % ALTUS GRP
PO BOX 92129
SOUTHLAKE, TX 76092

JAMIR LLC
119 TURLINGTON COURT
LIVINGSTON, NJ 07039

R C DIOCESE OF PATERSON
777 VALLEY ROAD
CLIFTON, NEW JERSEY 07013

TOWNSHIP OF WAYNE
475 VALLEY RD
WAYNE NJ 07470

TOWNSHIP OF WAYNE
475 VALLEY ROAD
WAYNE, NJ 07470

WAYNE PSC, LLC % HEKEMIAN & CO
505 MAIN ST, PO BOX 667
HACKENSACK, NJ 07601

Parcel Profile Report

Wayne Township

Highlighted feature(s)

Parcels (1)

BLOCK	LOT	QUAL	Owner	Street	City/State	Zip
2711	105		1195 1207 HAMBURG TPKE LLC	1015 HIGH MOUNTAIN RD	FRANKLIN LAKES NJ	07417

§

List of adjoining feature(s) that intersect 200 foot buffer from Parcels.

Parcels (8)

BLOCK	LOT	QUAL	Parcel Address	Owner Name	Street Address	City/State	Zip Code
2711	106		1195 HAMBURG TPKE	1195 1207 HAMBURG TPKE LLC	1015 HIGH MOUNTAIN RD	FRANKLIN LAKES NJ	07417
2711	107		1139 HAMBURG TPKE	FIRST NORTHERN STAR % ALTUS GRP	PO BOX 92129	SOUTHLAKE, TX	76092
2711	84		1512 ALPS RD	R C DIOCBSE OF PATERSON	777 VALLEY ROAD	CLIFTON, NEW JERSEY	07013
2711	85		1530 ALPS RD	TOWNSHIP OF WAYNE	475 VALLEY RD	WAYNE NJ	07470
2711	104.01		1530 ALPS ROAD	TOWNSHIP OF WAYNE	475 VALLEY ROAD	WAYNE, NJ	07470
2711	104		1211 HAMBURG TPKE	1211 HAMBURG LLC % PASHMAN REALTY	601 HAMBURG TURNPIKE	WAYNE, NJ	07470
3205	6		1176 HAMBURG TPKE	JAMIR LLC	119 TURLINGTON COURT	LIVINGSTON, NJ	07039
3205	7		1210 HAMBURG TPKE	WAYNE PSC, LLC % HEKEMIAN & CO	505 MAIN ST, PO BOX 667	HACKENSACK, NJ	07601

Garbage Zones (1)

Zone
WHITE

Recycling Zones (2)

Zone
15
10

Zoning (3)

Zone
B
R-15
MLR3D-3

Voting Districts (2)

Name
4
2

Soil Classification (2)

Map Unit Symbol

USRHVB

RkrB

Bedrock Geology (1)

Name

Towaco Formation

Parcel Profile Report - Map
Wayne Township

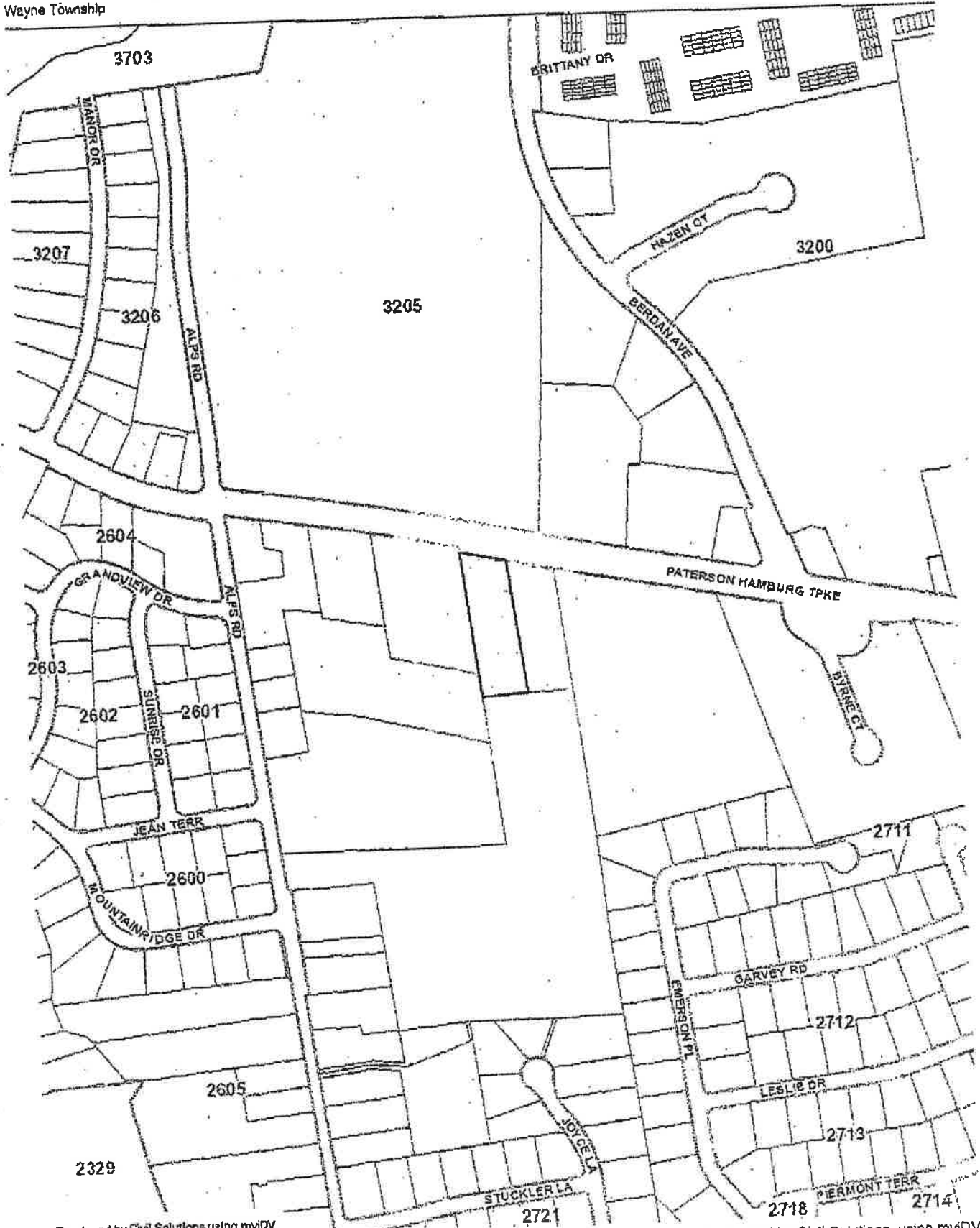

Legend

Base

- NJ County Boundaries
- Road Labels
- Blocks
- House Numbers
- Parcels
- Water Bodies
- Streams
- NJ Municipalities
 - BERGEN
 - ESSEX
 - MORRIS
 - PASSAIC